

PARSONS  
COMPANY



Rosetta Cottage Hall Road, Beetley, Dereham, Norfolk, NR20 4DE  
£695,000





## Rosetta Cottage Hall Road, Beetley, Dereham, Norfolk, NR20 4DE

£695,000

This attractive and immaculately presented detached cottage enjoys a rural position with superb countryside views. The spacious accommodation has been much enhanced by the current owners together with exceptional, well stocked landscaped gardens with independent studio. VIDEO TOUR AVAILABLE!

For room measurements please click on the floor plan option.

### Brief description

Rosetta Cottage is a charming detached cottage and has been much improved by the current owners whilst retaining the character features including the inglenook fireplaces and exposed beams.

The spacious accommodation is in excellent decorative order with a porch and large welcoming entrance hall with stairs and inglenook fireplace. This leads to a useful utility room and wet room.

The kitchen/breakfast room is nearly 20ft in length and boasts a Rangemaster cooker with two sets of French doors opening onto the patio area and garden.

The sitting room spans the width of the main house from front to back and has the second inglenook fireplace with wood burner and built in lighting.

The study with second staircase could be used for a variety of purposes (play room, snug, hallway etc) and provides access through to the downstairs cloakroom and bedroom 5 (which again could be used for a different purpose).



## Description



## Situation



null

Council Tax Band:

Available:

Floor Plans

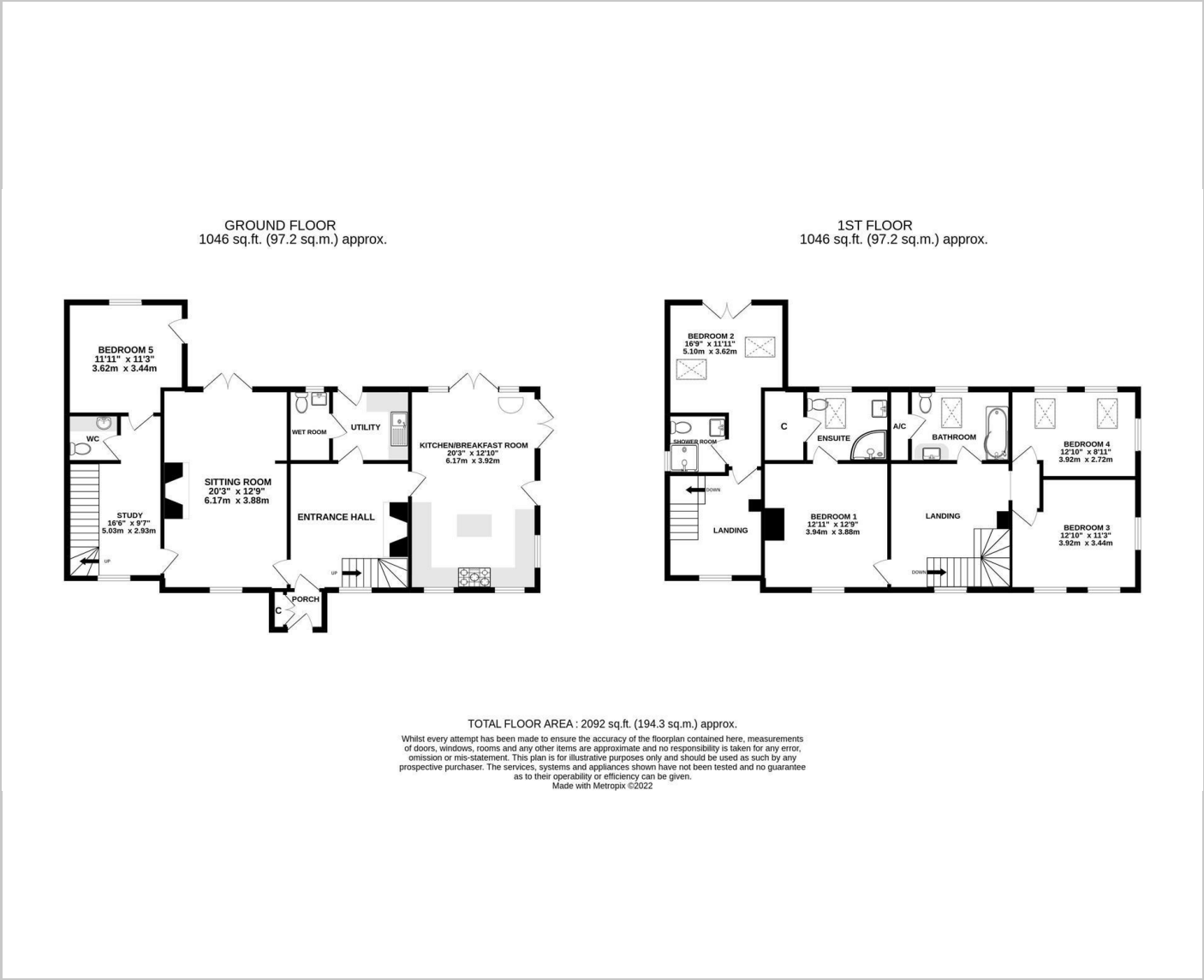

Area Map

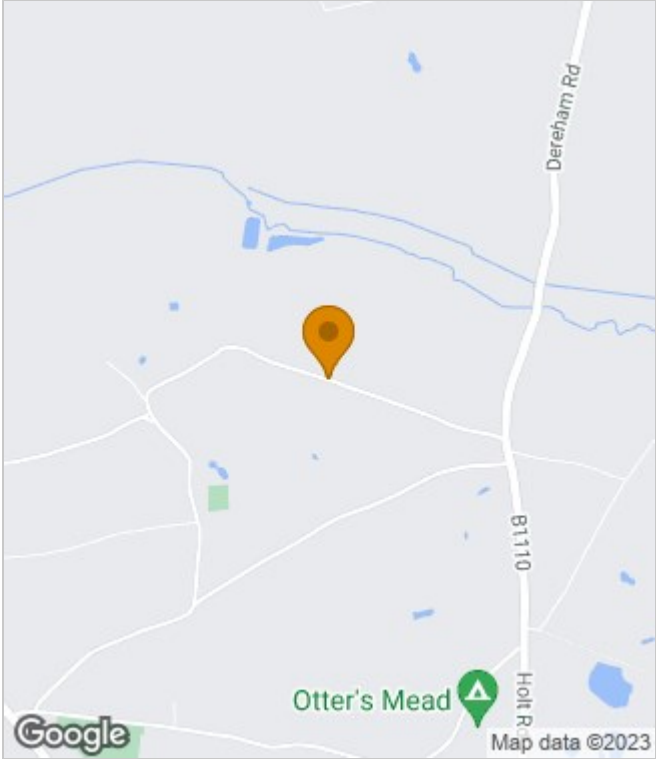

Energy Performance Graph

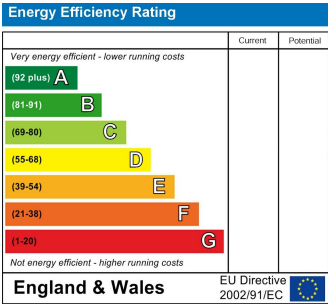

These particulars, whilst believed to be accurate are set out as a general outline only for guidance and do not constitute any part of an offer or contract. Intending purchasers should not rely on them as statements of representation of fact, but must satisfy themselves by inspection or otherwise as to their accuracy. No person in this firms employment has the authority to make or give any representation or warranty in respect of the property.